

3029 Stevens Ln.

San Jose, CA. 95148

PROPERTY SQF INFORMATION

Square Footage: 1,479 Sq Ft*

* Main Level 1,479

Square Footage: 700 Sq Ft*

* Garage 422

* Sun Room 278

APPROXIMATE TOTAL LIVING & NON-LIVING SPACE

Square Footage: 2,179 Sq Ft*

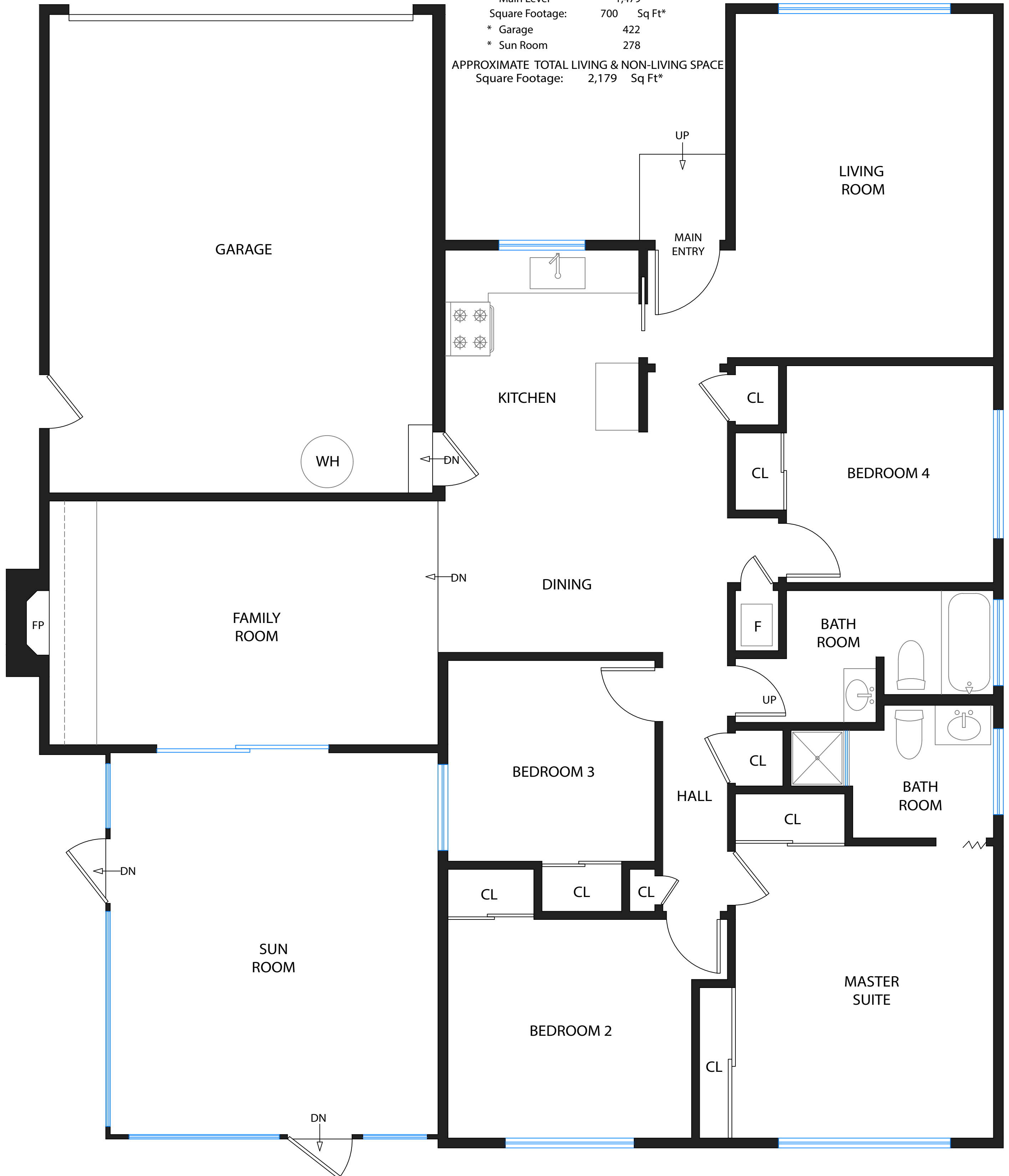

DISCLAIMER: RENDERING BY OPEN HOMES PHOTOGRAPHY. ALL MEASUREMENTS ARE APPROXIMATE AND MAY NOT BE EXACT. DO NOT RELY ON THE ACCURACY OF THIS FLOOR PLAN WHEN DETERMINING THE PRICE OF A PROPERTY OR MAKING DECISIONS REGARDING BUYING OR SELLING OF PROPERTIES WITHOUT INDEPENDENT VERIFICATION.